



SARASWATI Education Society's
SARASWATI Institute of Technology

Learn Live Achieve and Contribute

Kharghar, Navi Mumbai - 410 210.

VISION

"To incorporate technical & professional skills in Mechanical Engineers to fulfil industrial & social needs".

MISSION

- *To educate, guide, and mentor the students for academic excellence.*
- *To develop technical skills and discipline among the students as per the requirement of the industry.*
- *To impart ethics & social values by arranging social activities.*

SYME/SYAE

Subject Name: PDR/AWD

Sheet No. 2

Questions.

1. Draw Conventional representations of
 - A.Bevel gear
 - B.Semi-elliptic leaf spring with eyelets
 - C.Spring with square and flat ends
 - D.Rack and pinion gear
 - E.Compression spring with square section
 - F.Spiral spring
 - G.External Screw Threads
 - H.Spur gear
 - I. Worm Gear
 - J.Helical compressing spring with flat ends

K.Internal Screw threads

L.Semi-elliptic leaf spring

M.Cylindrical helical Compression spring of wire of circular cross section

2. Draw Conventional representations of

A.Diamond Knurling

B.Gate valve

C.Ball bearing

D.Splined shaft

E.Roller bearing

F.Reducing socket

G.Globe valve

H.Cross pipe joint

I. Rack and pinion

J.check valve

K.saddle key

3. Draw Conventional representations of

A.Conventional break for pipe.

B.Short break for pipe.

C.Long break for pipe.

d. I section or rolled section

E.Glass and Rubber

F.Cast iron

G. petrol

Rectangular section (wood)

I. Steel

j. Cement concrete.



SARASWATI Education Society's
SARASWATI Institute of Technology

Learn Live Achieve and Contribute

Kharghar, Navi Mumbai - 410 210.

VISION

"To incorporate technical & professional skills in Mechanical Engineers to fulfil industrial & social needs".

MISSION

- *To educate, guide, and mentor the students for academic excellence.*
- *To develop technical skills and discipline among the students as per the requirement of the industry.*
- *To impart ethics & social values by arranging social activities.*

SYME/SYAE

Subject Name: PDR/AWD

Sheet No. 3

Questions.

1. Draw symbol representing the characteristics of geometrical tolerance.
2. Draw conventional representation of the all forms of weld.
3. What is the meaning of symbol X and Y

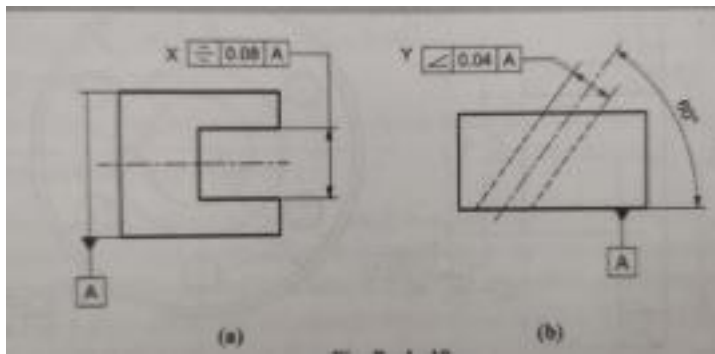

4. State the meaning of the symbol

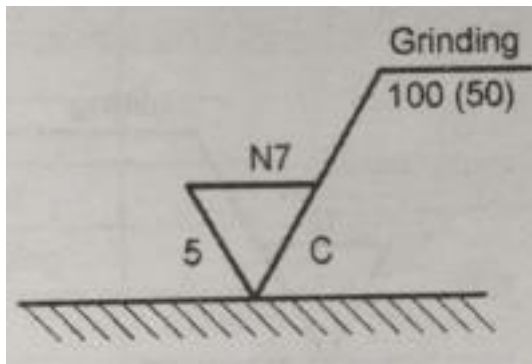

5. From the drawing answer the question

A. what is the meaning of a

B. what is the meaning of d

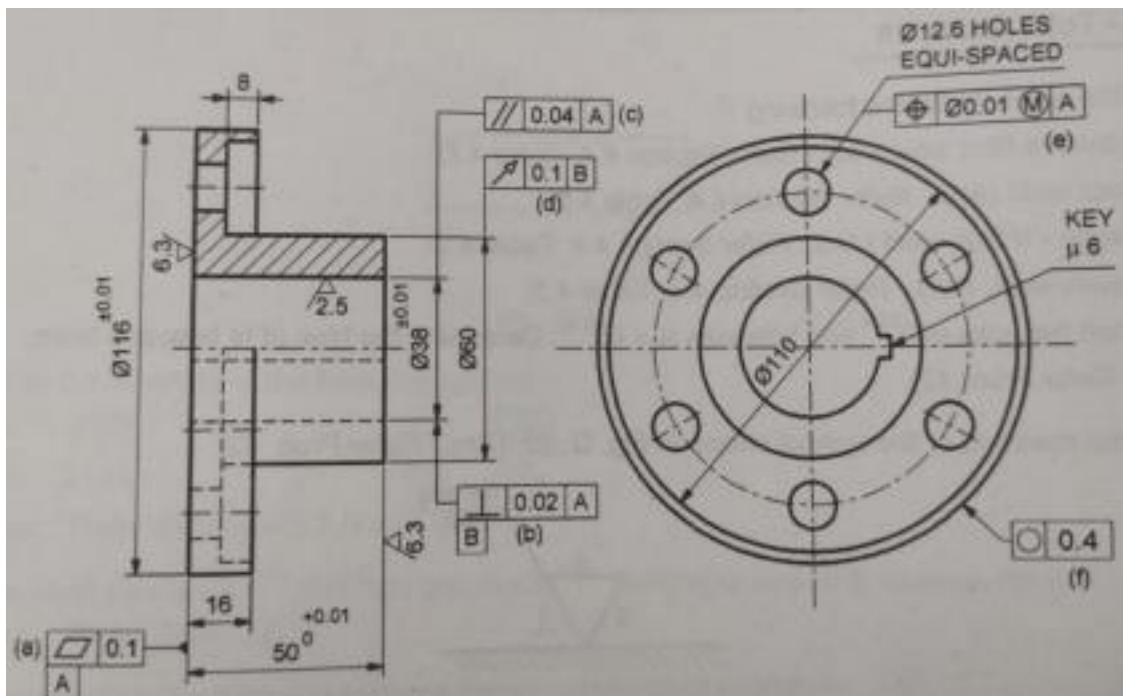

6. State the meaning of X and Y

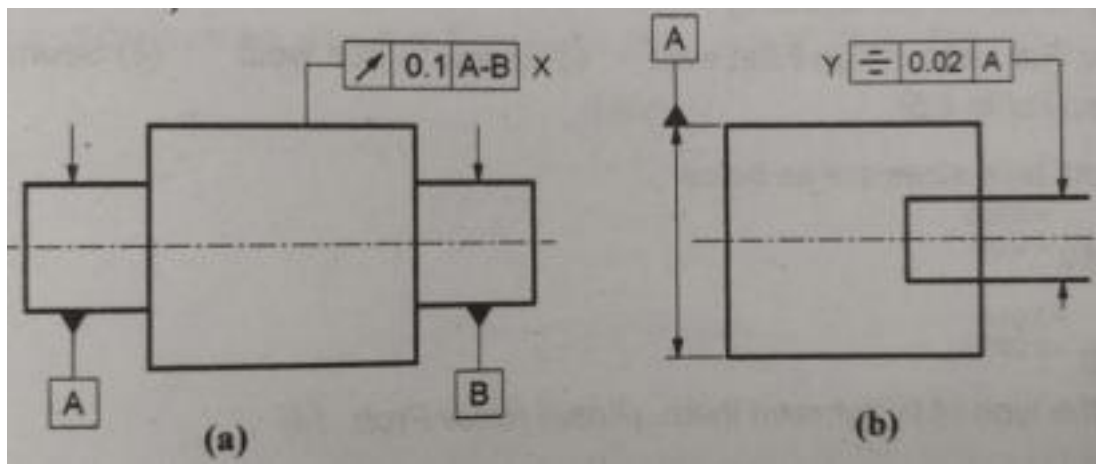



VISION

"To incorporate technical & professional skills in Mechanical Engineers to fulfil industrial & social needs".

MISSION

- To educate, guide, and mentor the students for academic excellence.
- To develop technical skills and discipline among the students as per the requirement of the industry.
- To impart ethics & social values by arranging social activities.

SYME/SYAE

Subject Name: PDR/AWD

Sheet No. 4

Questions.

1. Draw the production drawing of at following machining component showing dimensional and geometrical tolerance, surface finish.

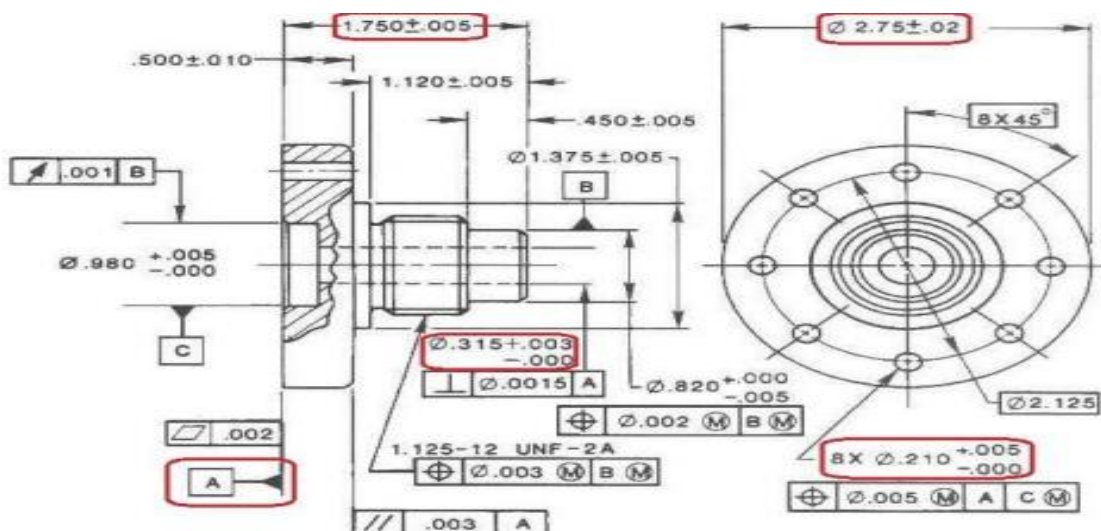

2. .Draw the production drawing of at following machining component showing dimensional and geometrical tolerance, surface finish.

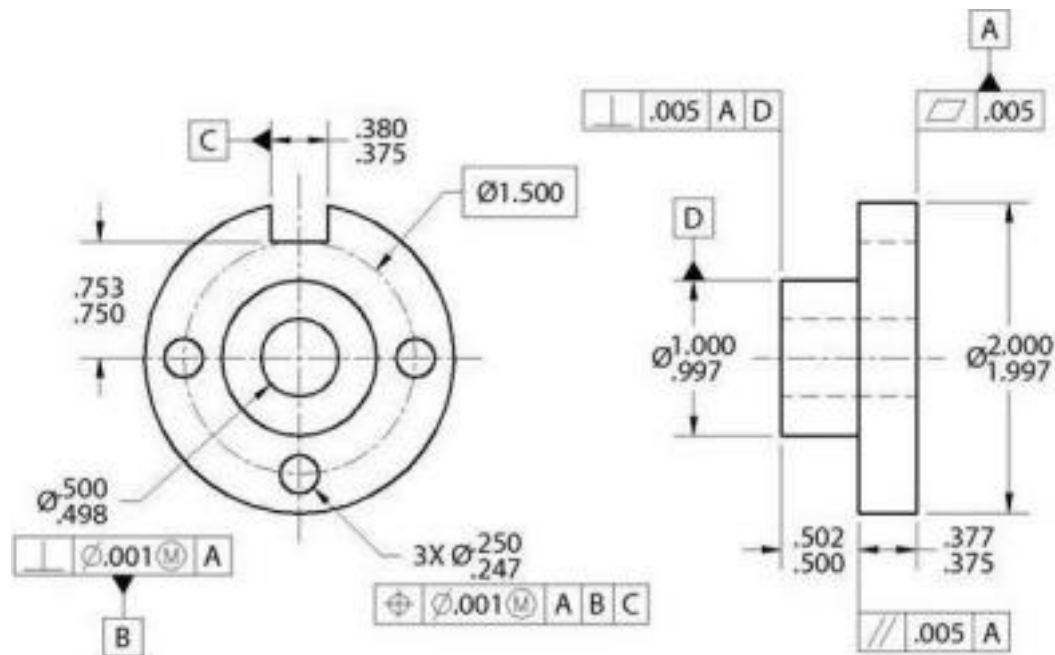

3. .Draw the production drawing of at following machining component showing dimensional and geometrical tolerance, surface finish.

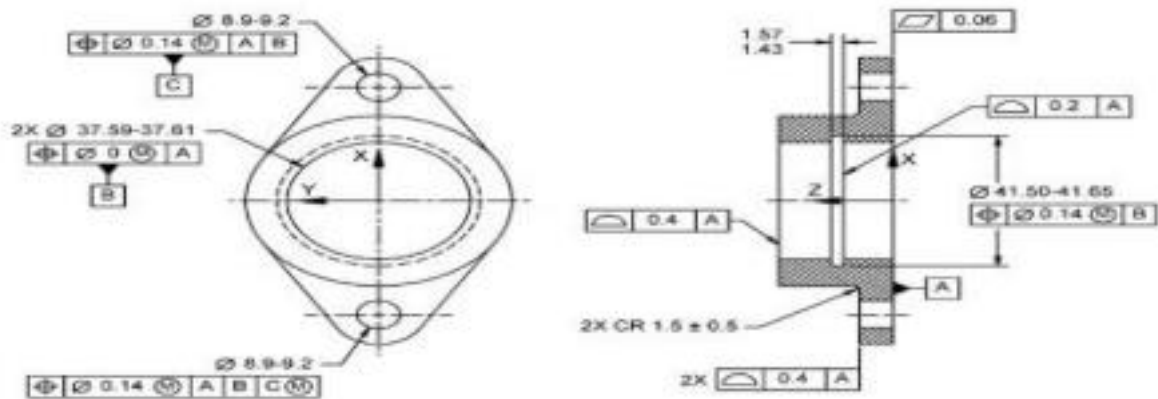

4. .Draw the production drawing of at following machining component showing dimensional and geometrical tolerance, surface finish.

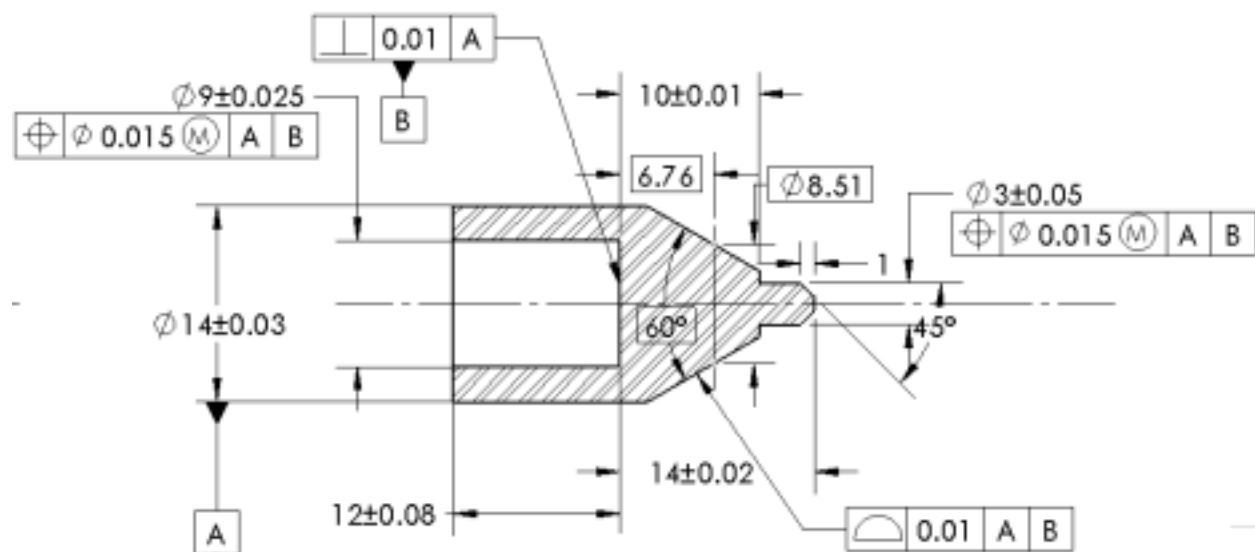



SARASWATI Education Society's
SARASWATI Institute of Technology

Learn Live Achieve and Contribute

Kharghar, Navi Mumbai - 410 210.

VISION

"To incorporate technical & professional skills in Mechanical Engineers to fulfil industrial & social needs".

MISSION

- *To educate, guide, and mentor the students for academic excellence.*
- *To develop technical skills and discipline among the students as per the requirement of the industry.*
- *To impart ethics & social values by arranging social activities.*

SYME/SYAE

Subject Name:PDR/AWD

Sheet No. 5

Questions.

Draw Detail to Assembly of following questions

1. Draw assembly of Universal Coupling from given details

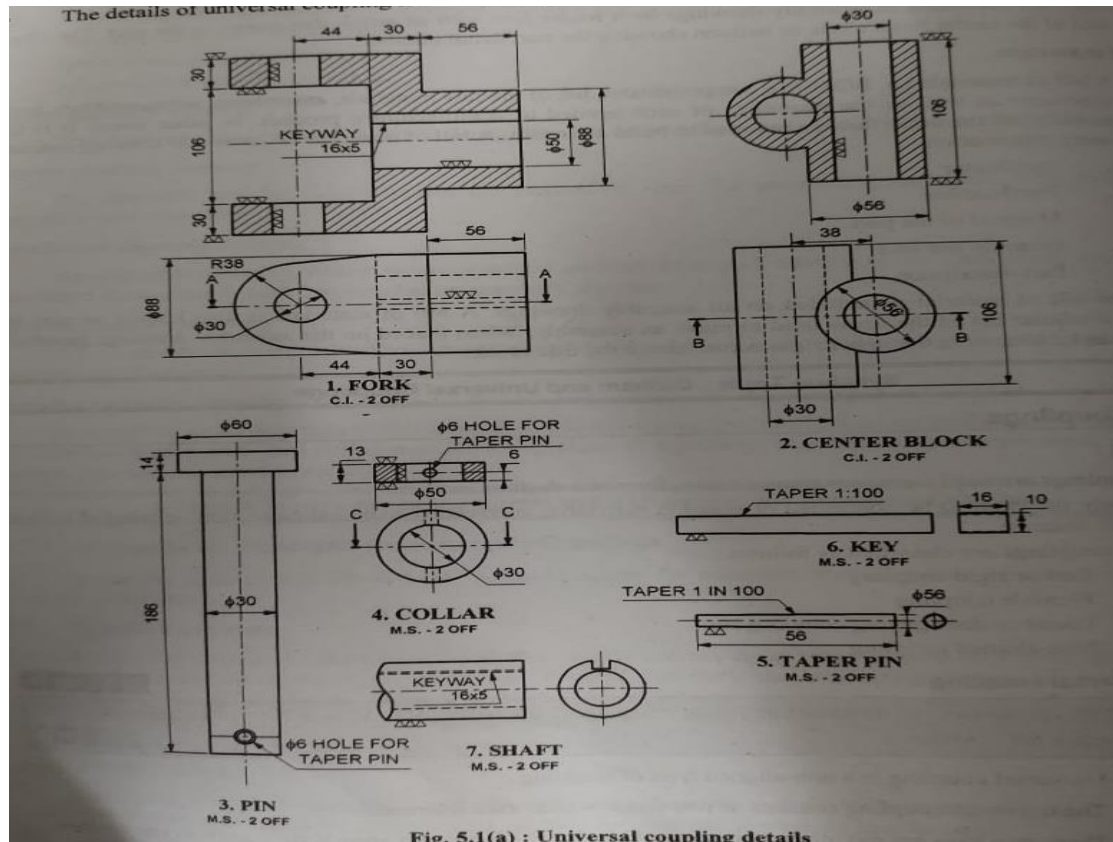
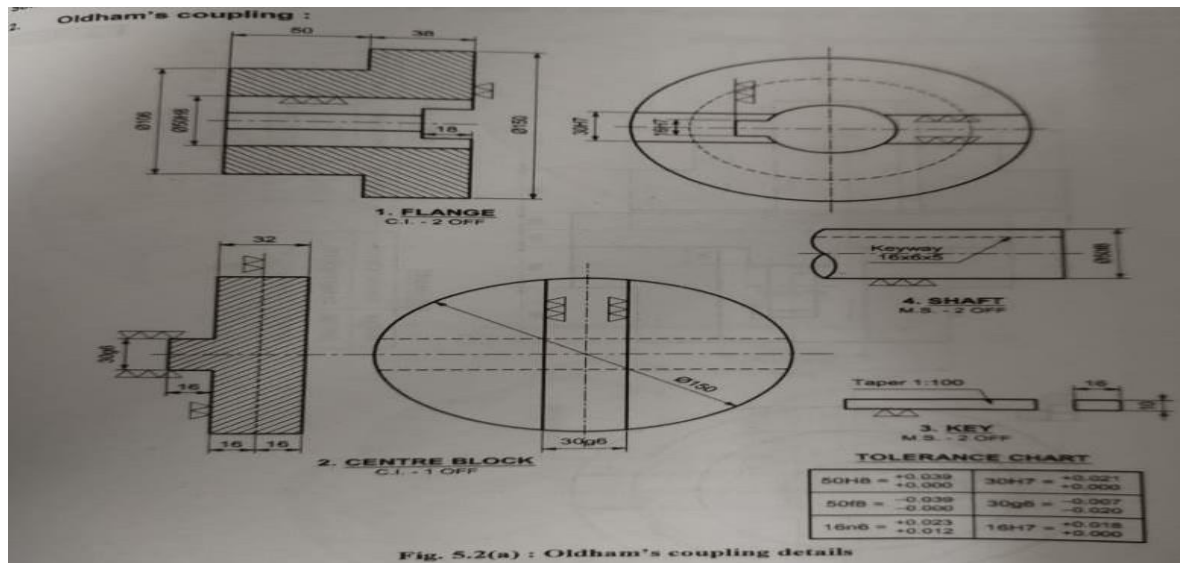

Fig. 5.1(a) : Universal coupling details



2. Draw assembly of Oldham Coupling from given details



3. Draw assembly of scerw jack coupling from given details

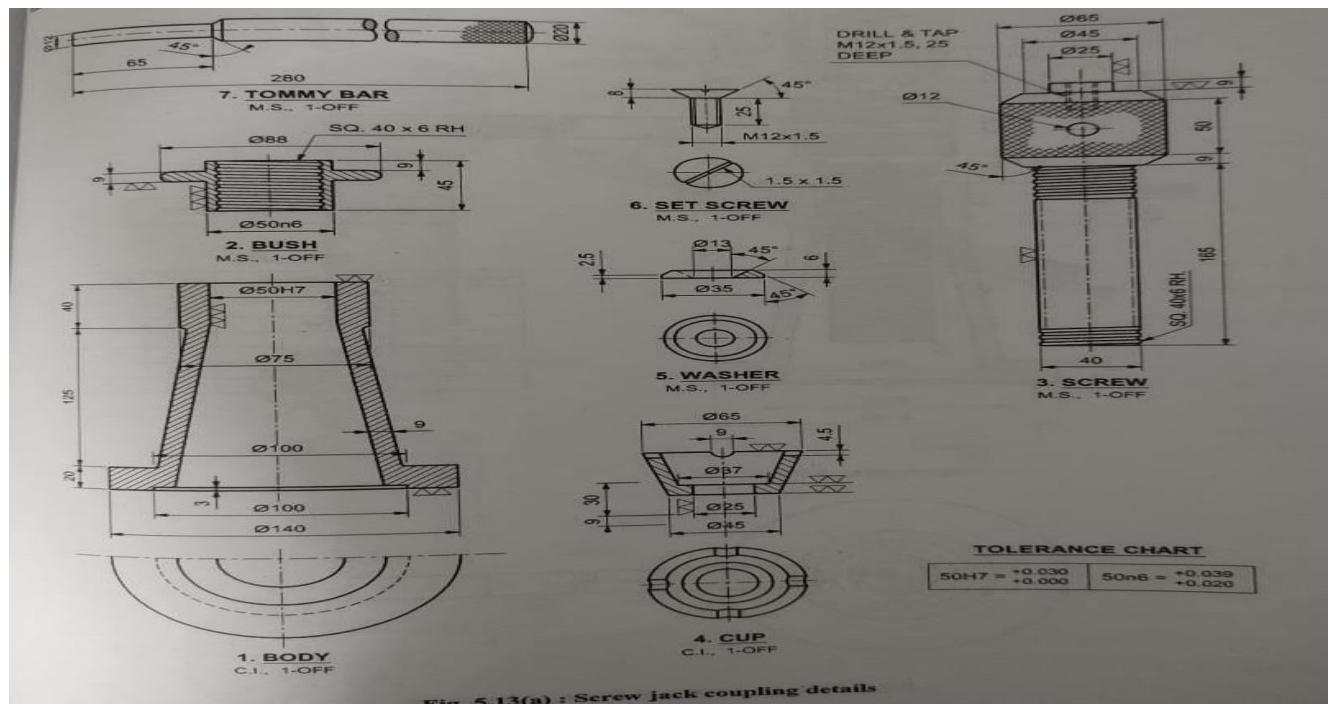



4. Draw assembly of Lathe tool post from given details

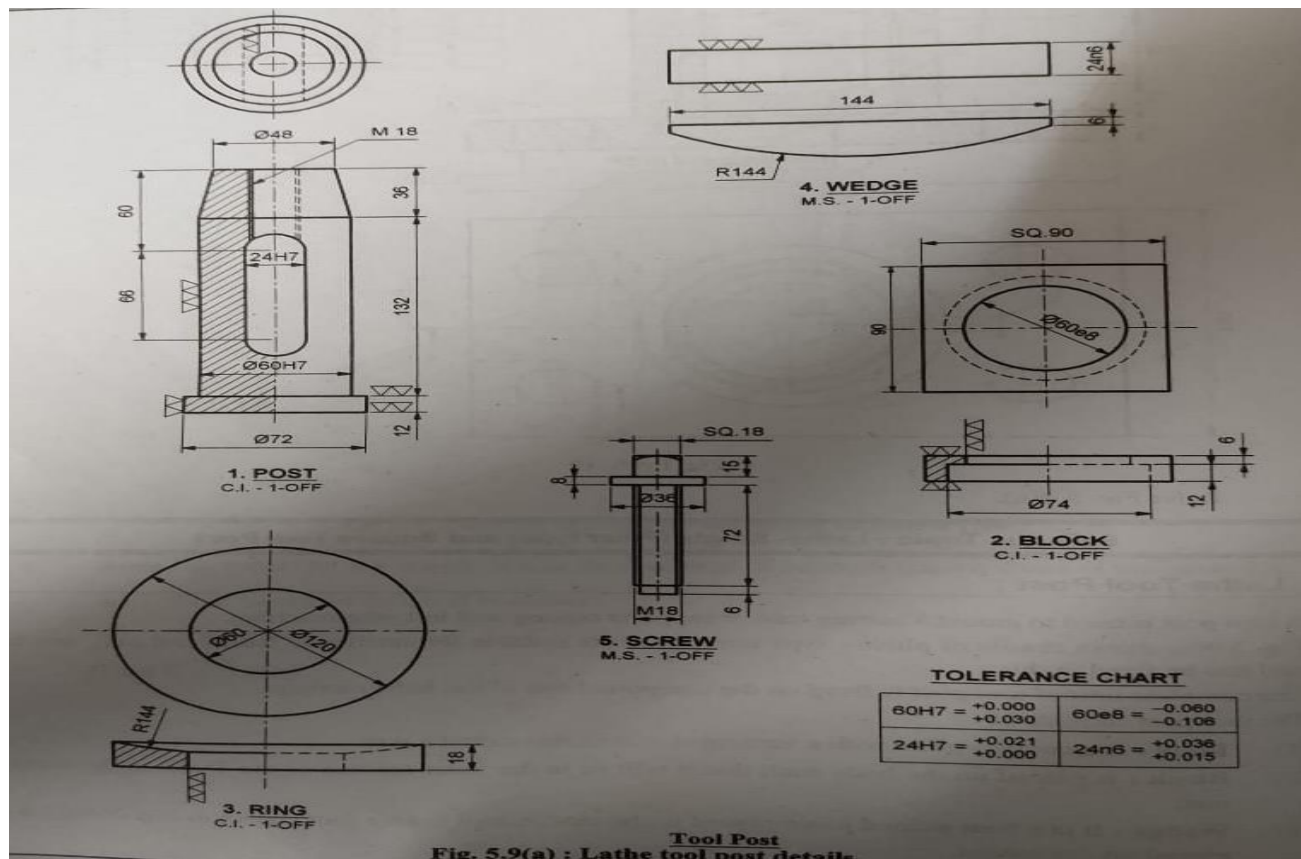

VISIO

"To incorporate technical & professional skills in Mechanical Engineers to fulfil industrial & social needs".

MISSION

- *To educate, guide, and mentor the students for academic excellence.*
- *To develop technical skills and discipline among the students as per the requirement of the industry.*
- *To impart ethics & social values by arranging social activities*

SYME/SYAE

SubjectName:PDR/AWD

Sheet No. 7 Questions.

Draw Assembly to Detail of following questions

1. Draw detail of connecting rod from given assembly.

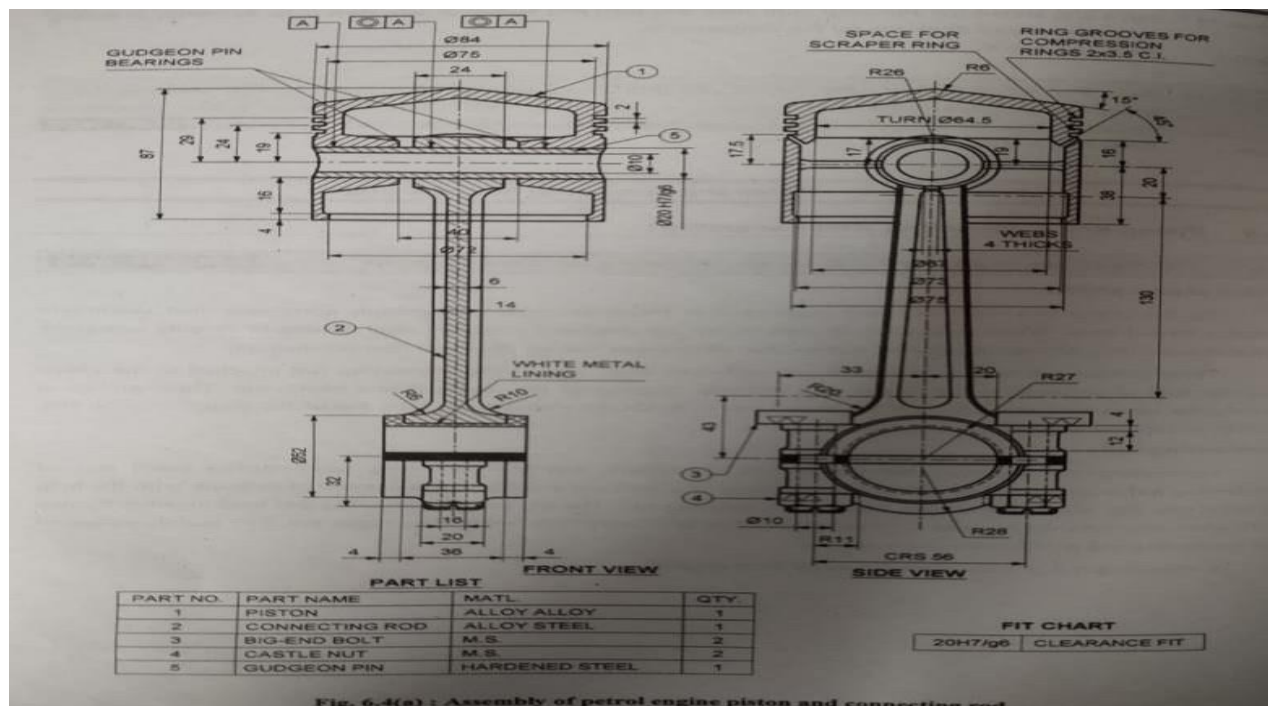
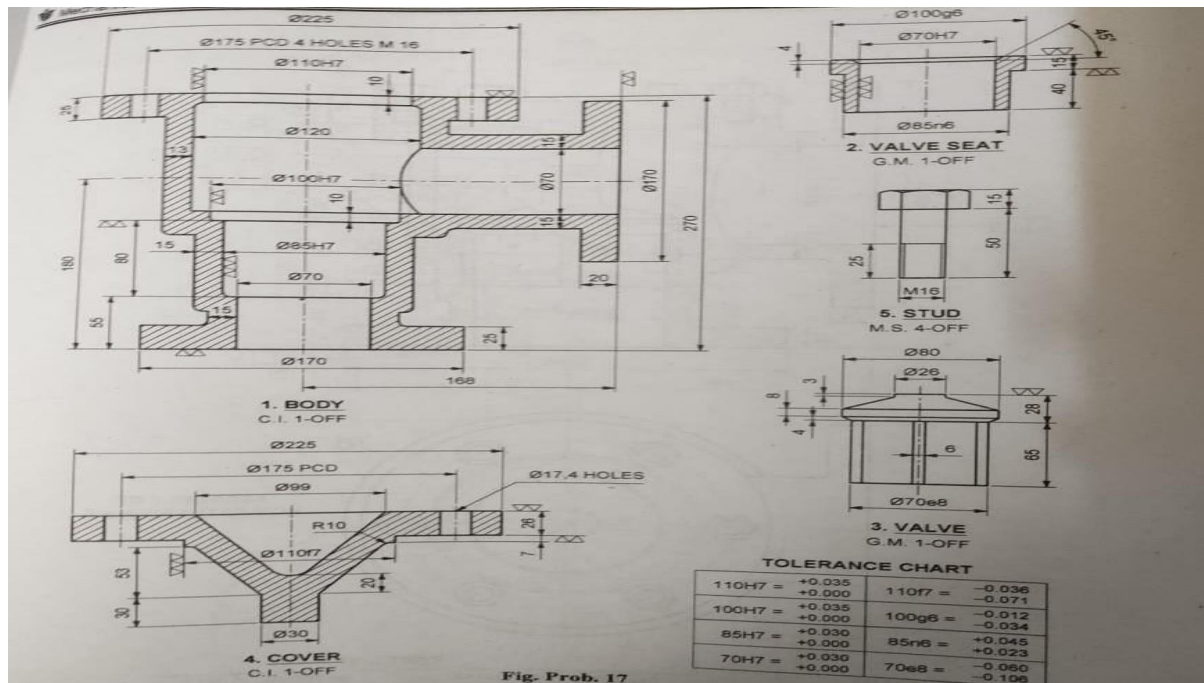

Fig. 6.4(a) : Assembly of petrol engine piston and connecting rod



2. Draw detail of non-return valve from given assembly.



3. Draw detail of foot step bearing from given assembly.

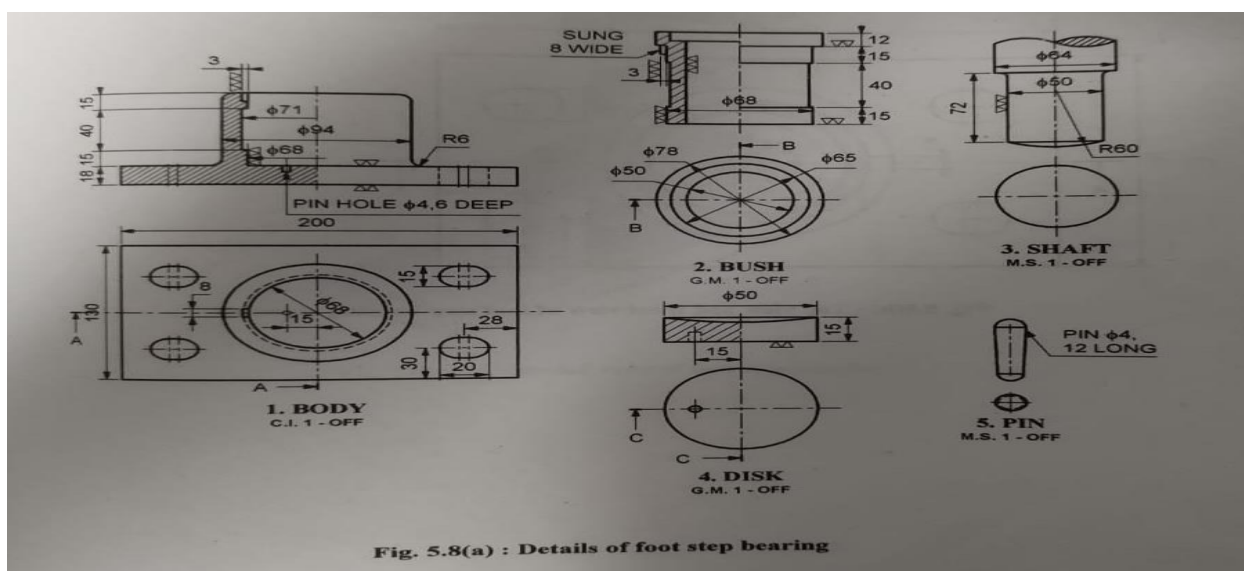



4. Draw detail of pedestal bearing from given assembly.

